

Mary G. Porter Traditional School
Specialty Program
Information Night

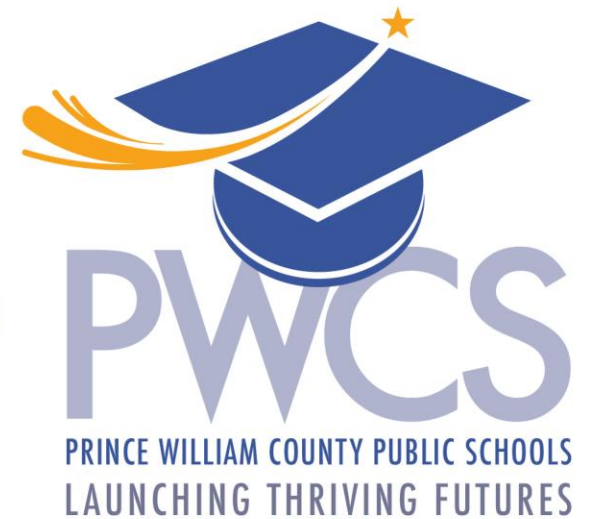

Goals for the Information Night



- Introduce the Porter Traditional Staff
- Review Porter Traditional School Profile
- School Program Opportunities
- School Program Expectations/Requirements

Introduction of Staff



Kaitlyn Engelmeier Foor
Principal



Joseph Wood
Assistant Principal



Beverly Johnson
Parent Liaison



Ms. Michele
Registrar/Lottery Coordinator



Laura Meres
Director of School Counseling

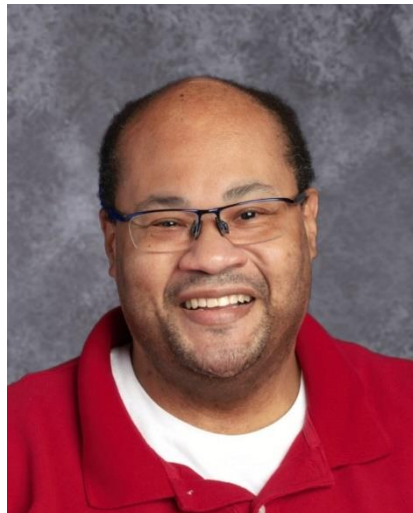

Arthur Lockamy
Middle School Counselor



Jessica Rose-Jones
Elem. School Counselor



Brooke Barker
Front Office



Mr. D
Front Office

Porter Traditional School Profile



Number of Students

Porter TRAD

679

Race/Ethnicity

Multiple Races (7.36%)

Hispanic (10.75%)

White (13.99%)

Asian (22.09%)

Black (45.66%)

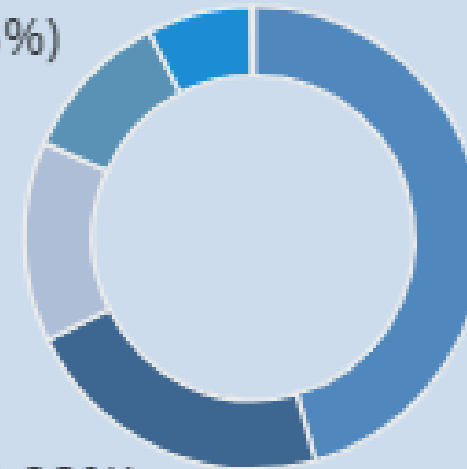

Grades 1-8

Porter Traditional School Profile



English Learners

EL (18.11%)

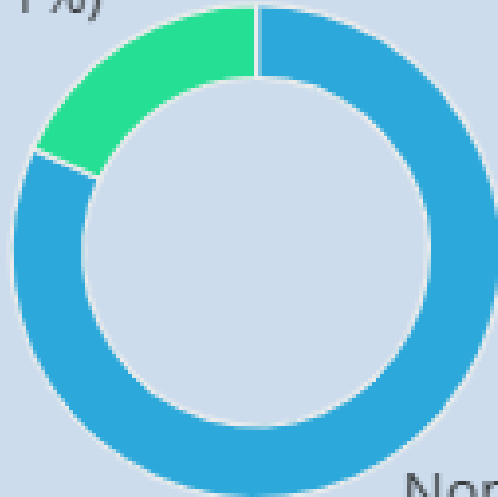

Non EL (81.89%)

Special Education

SPECED (7.66%)

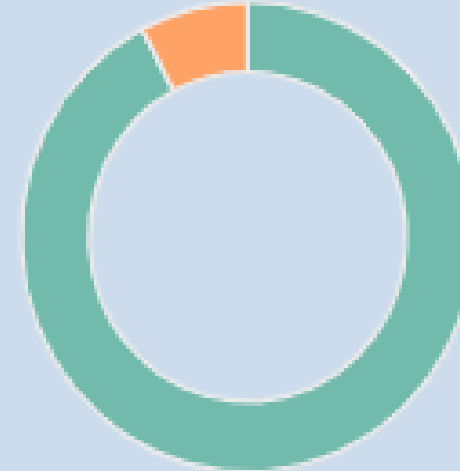

NON SPECED (92.34%)

Porter Traditional School Profile



Economic Status

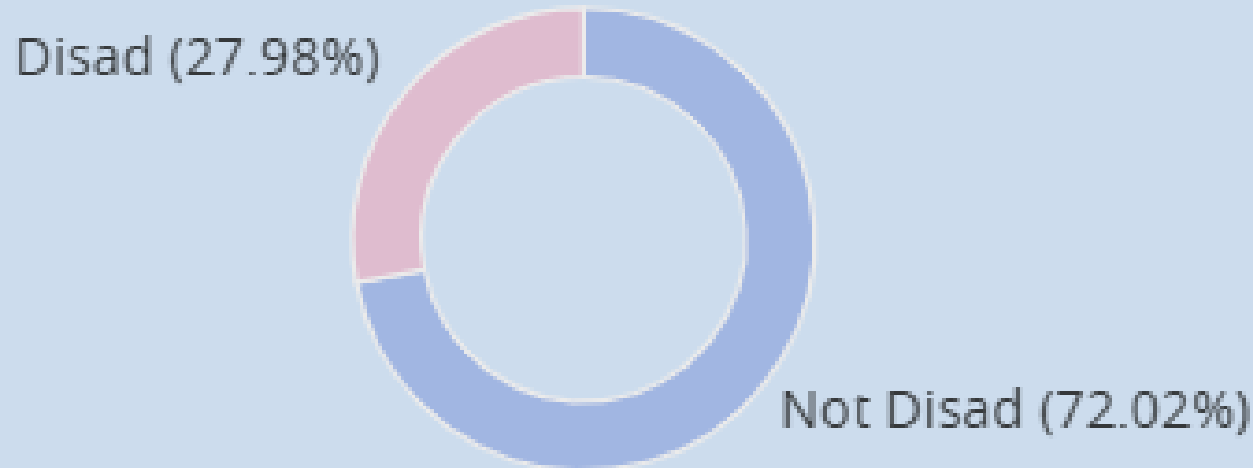

Gifted

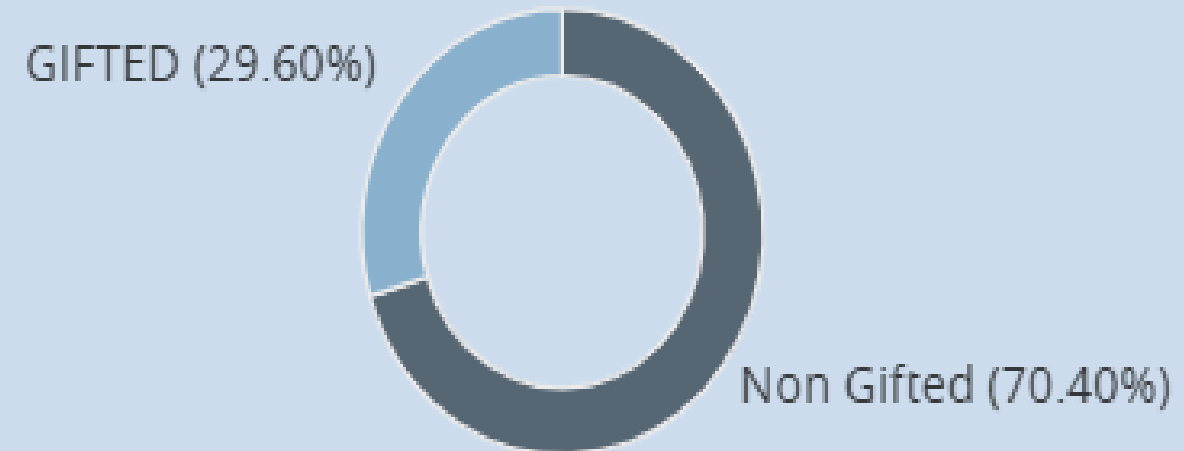



Student + Parents + Teachers = SUCCESS

"It takes a village to raise a child"

Carry Traditions from 1st – 8th Grade



PWCS Curriculum, Assessments, and Requirements

Support Services

- Reading Specialist
- Math Specialist
- Gifted
- ESOL
- Special Education
 - Level 1 and Level 2 Services
 - Including all related services

Encore –Elementary

- Art
- Music
- PE
- Strings (5th Grade)

Encore –Middle School

- Art
- Chorus, Band, Orchestra
- Intro to Technology
- Intro to Foreign Language
- Computer Science Discoveries
- TV Production
- Intro to STEM



PWCS Curriculum, Assessments, and Requirements

High School Credit Opportunities

- Spanish 1
- Spanish 2
- Algebra 1
- Geometry



- **iPads/Laptops**

- Students in grades 1-5 will receive an iPad and 6th-8th will receive a Laptop to be taken to and from school every day.
- Students will be issued their device the first week of school.
- It is expected for all students to charge their device nightly at home and bring it fully charged to school.
- Students will be issued a Microsoft account, supported by teachers and IT staff to create logins to the iPad as well as software for instructional resources.



• **WE NEED YOU! - Activities are based on volunteers**

- Robotics/FLL Robotics
 - National Junior Honor Society
 - Cooking Club
 - Aviation
 - Step Team
 - Basketball
 - Baseball
 - Girl Scouts
 - Tutoring Program
 - Debate Club
 - Math 24
 - Mathcounts
 - Biomedical Engineering
 - Elementary Chorus
 - Student Voice Committee
 - No Place for Hate
-and MORE!

School Day Information



First Day of School – August 19, 2024
Last Day of School – June 12, 2025

Bell Schedule

8:40am - Students begin to enter the building

- Breakfast begins

9:00am - Late Bell

3:40pm - Dismissal



Transportation



Busses

- Preferred method of transportation
- Specialty Stops
- Stop can be chosen based on family need
- Student will never be marked TARDY
- HERE COMES THE BUS app
- No Activity Buses

Release from Busses

- SAFETY
- Photo ID Required
- Middle School students need written permission to walk and approval by Principal
- Consistency by parents helps the driver
- Drivers understand Porter's expectations of safety

Transportation

Car Line/Walker

- Must follow carline rules (*on website and handed out*)
- Parking lot shuts down from 8:40-9:00am.
- Can only make a right hand turn out of the parking lot .
- Entrance into the building between 8:40-9:00am...you must get in the carline.
 - Field Trips
 - Volunteering
 - Dropping materials off
 - Meeting w/school staff
- Remain in your car and follow staff directions

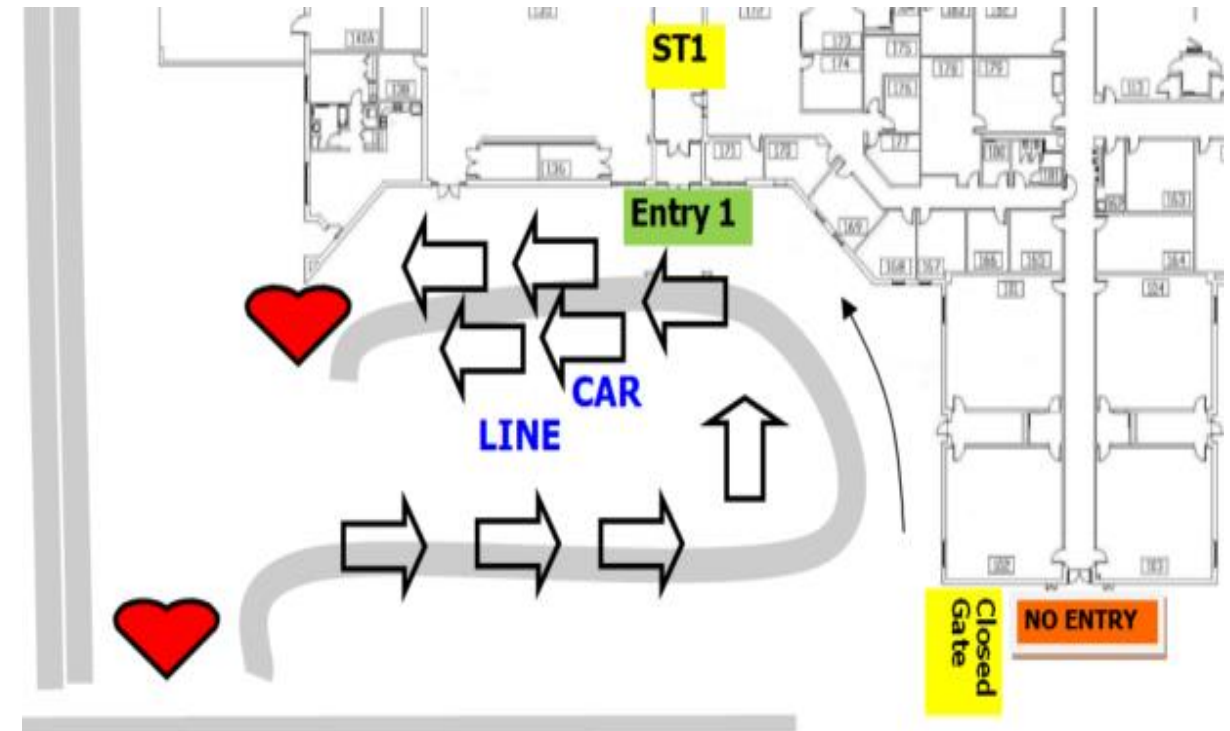

Evolv Detection System

- Weapons Detection System located in the front and the back entrances of the school.
- All students will enter through the detection system.
- Anyone who enters the building during instructional hours will be subject to enter through the EVOLV system or they will not be permitted to enter the building.
- Students will learn how to enter the building along with what materials may need to be taken out of their bags. Should the screener sound, the student's bag will be subject to search.
- To promote a smooth transition into the building, we discourage the use of:
 - 3-Ring Binders
 - Metal Eye Glass Cases
 - Back Packs with Wheels
 - Umbrellas (unless raining)



TRADITION - Uniform Policy



- Students are expected to abide by the Porter Dress Code every day.
- Only Solid Colors
- No holes, tears or stains in clothing or shoes.
- No crocs
- Collared Shirt on non-PE days
- PE Days – Students can wear crew neck shirt or spirit wear

SCHOOL COLORS

ALL CLOTHING MUST BE IN THESE COLORS

TOPS
Red, White, Navy, Light Blue, Black

BOTTOMS
Navy, Khaki, Black (NO DENIM/JEANS)

Financial assistance is available for families.

Submit an email to the Principal requesting additional resources for uniforms.

TRADITION - Uniform Policy



TRADITION - Star Qualities

- RESPECT
- PATIENCE
- RESPONSIBILITY
- COOPERATION
- HONESTY



- COMPASSION
- PERSISTENCE
- SENSE OF HUMOR
- COURAGE
- COURTESY





• **CONDUCT STANDARDS**

- ALL Porter students must maintain outstanding conduct. Porter students **MUST MAINTAIN** an “S” or “O” in Conduct in all Core classes each grading period. Any student receiving a discipline referral in two consecutive grading periods will be placed on **DISCIPLINARY PROBATION**

• **VOLUNTEER HOURS STANDARDS**

- Porter students are **REQUIRED** to participate in school and/or community service/volunteer projects each year.
- The required number of hours is respective to their grade level:
 - Grades 1-3.....10 hours
 - Grades 4-5.....15 hours
 - Grades 6-8.....20 hours
- Porter parents/guardians are **REQUIRED** to complete 10 school related volunteer hours per child enrolled at Porter. Donations may be made for up to 3 hours per student.

ALL VOLUNTEER HOURS MUST BE COMPLETED BY THE LAST DAY OF SCHOOL

Volunteer Opportunities

- Volunteer Website on Porter's Webpage
- Check with your student's teacher
- Field Trips
- Cafeteria
- Guest Reader
- PTO Events/Dances
- Clubs
- PTO Meetings
- Advisory Council Meetings
- Family Engagement Events



**DO NOT WAIT UNTIL THE LAST MINUTE.
CALL THE FRONT OFFICE IF YOU NEED HELP.**



ATTENDANCE

- Regular attendance is important for success
- Parents are responsible for their child's attendance at school. Parents should make sure absences are used for a real emergency or illness.
- 5+ Unexcused absences or tardies will result in an initial attendance conference and an attendance letter.
- 10+ Unexcused absences or tardies will result in an interagency team meeting and a second attendance letter.
- If we see trends with EXCUSED absences or tardies, an attendance letter will be sent outlining our attendance policy.



PWCS BUS TRANSPORTATION

- Riding on a PWCS school bus is a privilege, and rules are established to ensure the safety of ALL children riding the school bus. PWCS bus transportation rules are listed in the Code of Behavior; please read and discuss these rules with your child. All students need to be aware of the bus rules.
- Students who are not met at the bus stop by a parent/guardian/responsible person will be returned to the school, where they will need to be picked up. Repeated failure to comply with these expectations may result in the loss of a student's bus transportation privileges.

Carline Procedures

- Porter administration, along with input from the VDOT, PWC Police, and PWCS Risk Management, have established a set of carline and parking lot procedures for your child's safety, as well as all involved with the carline. It is imperative to everyone's safety and well-being that these procedures be adhered to.
- Parents/Guardians/Responsible persons tasked with picking up a student in the carline must follow these procedures; repeated failure to do so may result in the student's transfer being revoked for the following school year.

Specialty Program Process



- Application must be complete by the deadline in Feb. through the online portal
- There are no prerequisites for the program other than completed application.
- Preference to Siblings
- FULL LOTTERY PROCESS
- Acceptance depends on OPEN seats
- Movement usually happens in SUMMER
- We take students until Sept. 30

Specialty Program Process



- Important Dates
 - Application open Nov. 1 – Feb. 1.

